

# 58BW CASEMENT HI Window



Built to the highest UK standards, the 58BW Window System delivers a high performance and cost-effective solution with impressively narrow profiles. Equally at home on residential and commercial projects, the system is available in a number of formats including Top Hung, Side Hung and French Casement.

The system's clean lines and advanced functionality meet the demands of almost every modern building construction. Its competitive pricing also makes it a highly popular choice with specifiers both in the UK and around the globe. In addition to being certified and tested to PAS 24, the 58BW also holds a Green Guide 'A' rating.

#### DESIGN FEATURES

- › Tested to PAS 24
- › Integrated deep head profiles for ease of trickle ventilation
- › Unique polyamide thermal break design to improve thermal performance
- › Casement system sightlines to match the Tilt-Before-Turn window sightlines
- › Reverse rebate option for internal glazing throughout

#### OPTIONS

- › Available in two frame depths: 58mm or 70mm
- › Supports both open-in and open-out projects
- › Internally or externally glazed to accommodate low and high-rise projects
- › Glazing 24mm–40mm
- › Available in the following configurations: Top Hung, Side Hung, Bottom Hung, Fixed Light, Multi-light and French Casement
- › Available for Lifetime Homes (LFT)
- › Dedicated fixing straps for ease of installation
- › Designed with a Euro Groove to accommodate standard locking hardware
- › Smoke vent certification compliance to EN12101-2:2003 Annex G
- › Available in single or dual colour polyester powder coating, texture and anodised finishes

## SPECIFICATIONS

Performance and accreditations	58BW CASEMENT HI
U-Value (Double Glazing)	1.4 W/m²K
U-Value (Triple Glazing)	1.2 W/m²K
Window Energy Rating (WER)	B - C
BRE Green Guide Rating	A rated
Air Permeability	Class 4 (600 Pa)
Water Tightness	Class 9a (600Pa)
Wind Resistance	Class E2400 (2400 Pa)
Security	PAS 24
3rd Party Certification Q-Mark	✓

### System

Depth	58 & 70mm
-------	-----------

### Configurations

Opening	Open-Out
Top Hung	✓
Side Hung	✓
Bottom Hung	✓
Tilt & Turn	-
Fixed Light	✓
Multi-Light	✓
French Casement	✓

### Size and weight limits

#### Top Hung

Max Size (mm)	1750w x 2500h
Min. Size	300w x 350h
Max Weight	180kg

#### Side Hung

Max Size (mm)	838w x 1750h
Min. Size	300w x 300h
Max Weight	55kg

#### Bottom Hung

Max Size (mm)	1750h x 1750w
Min. Size	350h x 350w
Max Weight	45kg (5 hinges)

#### Butt Hinges (Side & Bottom Hung)

Top hung (max weight)	40 Kg
Side hung (max weight)	24 Kg

#### Fixed Light

Max Weight	250kg
------------	-------

### Glazing

Glazing Options Internal Bead	Internal & External Bead
Glazing Thickness **	24mm - 40mm

### System Features

Single Colour	✓
Dual Colour	✓
Textured Finish	✓
Anodised Finish	✓
Multi-Point Locking	✓
Smoke Vent Compliance	✓
Sightline (Frame to Vent)	75mm
Sightline (Vent to Mullion)	89mm
Sightline (Fixed Light)	43mm

\*\*Glazing thickness: Other thicknesses may be possible dependant on profile combinations specified. Fabricators should refer to AluK technical manual glazing section for details.

## CAD CROSS SECTIONS AND THERMAL PROFILE

Additional details are available on request.

➤ 58BW CASEMENT HI HEAD

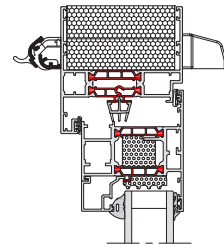

➤ 58BW CASEMENT HI JAMB

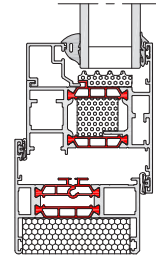

➤ 58BW CASEMENT HI MULLION

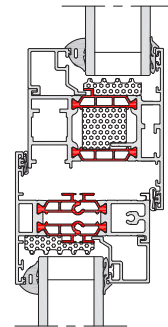

➤ 58BW CASEMENT HI THERMAL PROFILE

